

Flytrap Commercial™ AQUA

SAFETY INFORMATION

Please read these instructions carefully and store in a safe place for future reference.



Read User Manual



For Indoor Use Only

- This appliance is to be kept out of the reach of children.
- This appliance can be used by children aged from 8 years and above and persons with reduced physical, sensory or mental capabilities or lack of experience and knowledge if they have been given supervision or instruction concerning use of the appliance in a safe way and understand the hazards involved.
- Cleaning and user maintenance shall not be made by children without supervision.
- Children should be supervised to ensure they do not play with the appliance.
- **Warning:** This appliance must be earthed. If the supply cord is damaged, it must be replaced with a special cord or assembly available from the manufacturer or its service agent.
- This appliance is not suitable for use in barns, stables, and similar locations or in locations where flammable vapour or explosive dust is likely to exist.

WIRING INSTRUCTIONS

The wires in the mains lead are coloured in accordance with the following code:

BLUE = NEUTRAL

BROWN = LIVE

YELLOW & GREEN = EARTH

As the colours of the wire in the mains lead of this appliance may not correspond with the colour marking identifying the terminals on your plug, proceed as follows:

- The wire which is coloured BLUE must be connected to the terminal which is marked with the letter N.
- The wire which is coloured BROWN must be connected to the terminal which is marked with the letter L.
- The wire which is coloured YELLOW & GREEN must be connected to the terminal which is marked with the letter E or the symbol ⚡

GUARANTEE

Flytrap Commercial™ Aqua has a three-year guarantee and if maintained as recommended in these instructions should continue to work for many years. Use of non-approved consumables may invalidate the guarantee. The guarantee does not cover consumables (UV tubes, glueboards), breakdown due to misuse, incorrect operation or use in an incorrect application.

CONTENTS OF PACKAGE

- 1x Flytrap Commercial™ Aqua insect light trap
- 2x fluorescent UV lamp (fitted)
- 1x Glupac® glueboard
- 2x Screws and wall plugs

POSITIONING AND GUIDANCE FOR USE

Flytrap Commercial™ Aqua should ideally be fixed around two meters above the ground, preferably in the darkest place within the area to be protected. Do not position the unit close to windows, skylights or other sources of light, or where it may be obscured by furniture, doors or other obstacles. Ideally, Flytrap Commercial™ Aqua should be visible from every part of the area to be protected.

Flytrap Commercial™ Aqua should ideally be in operation for 24 hours a day, ensuring your premises are kept free of flying insects. Insects are most attracted to Flytrap Commercial™ Aqua unit at night when there is no competition from daylight or other light sources.

INSTALLATION

Installation should be carried out by service personnel only.

Flytrap Commercial™ Aqua can be mounted in three different ways as shown in the mounting options section of this document. Keep out of the reach of children. Once installed in position, fit the glupac® glueboard in position as described in the glueboard replacement section of this document. Flytrap Commercial™ Aqua should then be hard wired into an appropriate power supply. Do not fit a non-IP rated plug to this unit, if intended to be used in areas where hosing down is required.

If wall mounted, the optional glueboard clips can be used to securely hold the glueboard in position. The two clips should be simply pushed onto the top metal lip of the stainless steel housing. As the glueboard is inserted, simply lift the end of each clip slightly to allow the glueboard to pass between the clip and metal housing, then release.

CLEANING

Cleaning should be carried out by service personnel only, after ensuring that the unit is disconnected from the mains supply. It is recommended that cleaning is carried out regularly when the glueboard is replaced. Once the glueboard is removed, the unit should be thoroughly wiped down with a damp cloth, removing any build up of dirt. Ensure the unit is completely dry before reconnecting it to the power supply.

MOUNTING FIXING CENTRES

METHOD	FTC30 Aqua	FTC40 Aqua	FTC80 Aqua
Slimline	305mm	458mm	458mm
Discreet	305mm	458mm	458mm
Suspended	494mm	648mm	648mm

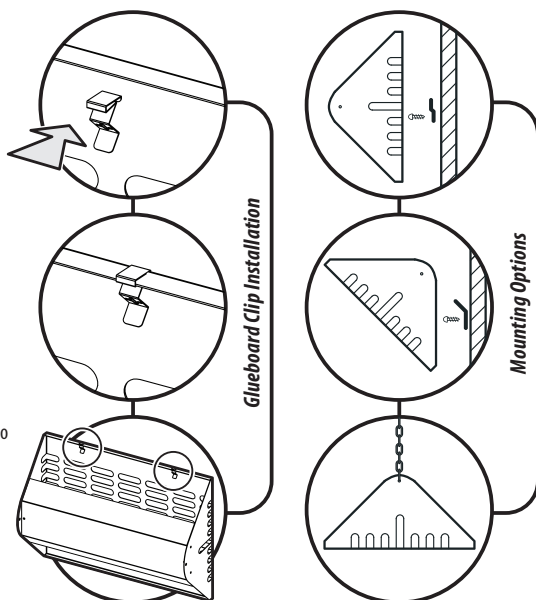

GLUEBOARD REPLACEMENT

Before replacing the glueboard, always ensure that the unit is disconnected from the mains supply.

The glueboard should be replaced every month with a genuine glupac® glueboard. Use of non-approved glueboards may invalidate your guarantee.

To replace the glueboard:

1. Remove the used glupac® glueboard by simply releasing from the metal outer and either retain for catch evaluation or dispose of it hygienically.
2. Remove the protective release paper from the new glupac® glueboard.
3. Fold the locating flap into position along the score line.
4. Slowly slide the new glupac® glueboard into position with the adhesive side facing the tubes.

Always ensure the selected genuine glupac® glueboards are compatible with your unit, available from your PCO or Pelsis Ltd.

TUBE REPLACEMENT

Before replacing the tubes, always ensure that the unit is disconnected from the mains supply.

To ensure the efficiency of Flytrap Commercial™ Aqua in catching flying insects, the shatterproof UV tubes should be replaced annually. After twelve months the phosphor coating that emits the correct wavelength of UV light has burnt away and the UV output is diminished substantially.

To replace the UV tubes:

1. Unscrew the two tube holder end caps providing a waterproof seal.
2. Rotate the tube through 90°, freeing it from the tube holders.
3. Pull the tube away from the chassis.
4. Dispose of the used UV tube in conjunction with local WEEE regulations.

STARTER REPLACEMENT

Before replacing the starters, always ensure that the unit is disconnected from the mains supply.

The starters provide an extra spark to initially light the UV tube. Starters wear out and should be replaced at the same intervals as the UV tubes.

To replace the starters:

1. Remove the IP rated starter covers by rotating anti-clockwise.
2. Rotate the starter anti-clockwise.
3. Pull the starter free from the unit.

SPECIFICATION / REPLACEMENT PARTS

Unit	FTC30 Aqua	Unit	FTC40 Aqua	Unit	FTC80 Aqua
Voltage	230V ~ 50Hz	Voltage	230V ~ 50Hz	Voltage	230V ~ 50Hz
Dimensions(mm)	494 x 352 x 155	Dimensions(mm)	648 x 352 x 155	Dimensions(mm)	648 x 352 x 155
Coverage	80 Sq. Meters	Coverage	120 Sq. Meters	Coverage	240 Sq. Meters
Weight	3.5 Kg	Weight	4.3 Kg	Weight	4.7 Kg
Light Output	30W	Light Output	40W	Light Output	80W
Tubes	2 x TPX15-18S	Tubes	2 x TPX18-24S	Tubes	2 x TPX36-24S
Starter	2 x I154	Starter	2 x I154	Starter	2 x I154
Glueboards (x6)	INF060 (Yellow)	Glueboards (x6)	INF061 (Yellow)	Glueboards (x6)	INF061 (Yellow)



For private households: Information on Disposal for Users of WEEE

This symbol on the product(s) and / or accompanying documents means that used electrical and electronic equipment (WEEE) should not be mixed with general household waste. For proper treatment, recovery and recycling, please take this product(s) to designated collection points where it will be accepted free of charge. Alternatively, in some countries, you may be able to return your products to your local retailer upon purchase of an equivalent new product. Disposing of this product correctly will help save valuable resources and prevent any potential negative effects on human health and the environment, which could otherwise arise from inappropriate waste handling. Please contact your local authority for further details of your nearest designated collection point. Penalties may be applicable for incorrect disposal of this waste, in accordance with your national legislation.

For professional users in the European Union

If you wish to discard electrical and electronic equipment (EEE), please contact your dealer or supplier for further information.

For disposal in countries outside of the European Union

This symbol is only valid in the European Union (EU). If you wish to discard of this product, please contact your local authorities or dealer and ask for the correct method of disposal.

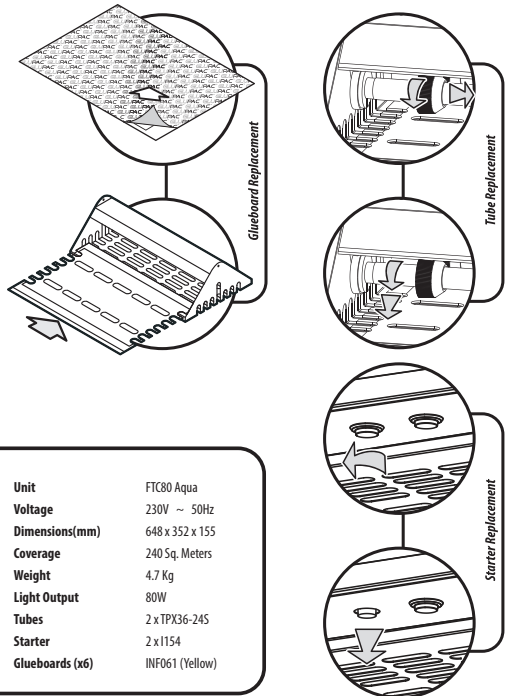

We are constantly developing our products to meet the evolving standards of our customers and as such, information in our instruction manuals may change.

Please visit www.insect-o-cutor.co.uk for the latest version of this manual. It is not intended that this manual forms part of any contract with Pelsis Ltd.

©2023 Pelsis